



FAQs - control - Outdoor

What is io?

- New protocol in Outdoor
- Communication with **feedback**
- 1 & 2-way communication possible
- RTS is only 1-way
- Example 1: with 1 way -> screen is up or down
with 2 way -> exact position is visible on the remote control

Example 2: control the screen, but remote control is out of range screen
-> result with 1 way remote: nothing happens
-> result with 2 way remote: message on the remote



io installation

- Motor control io

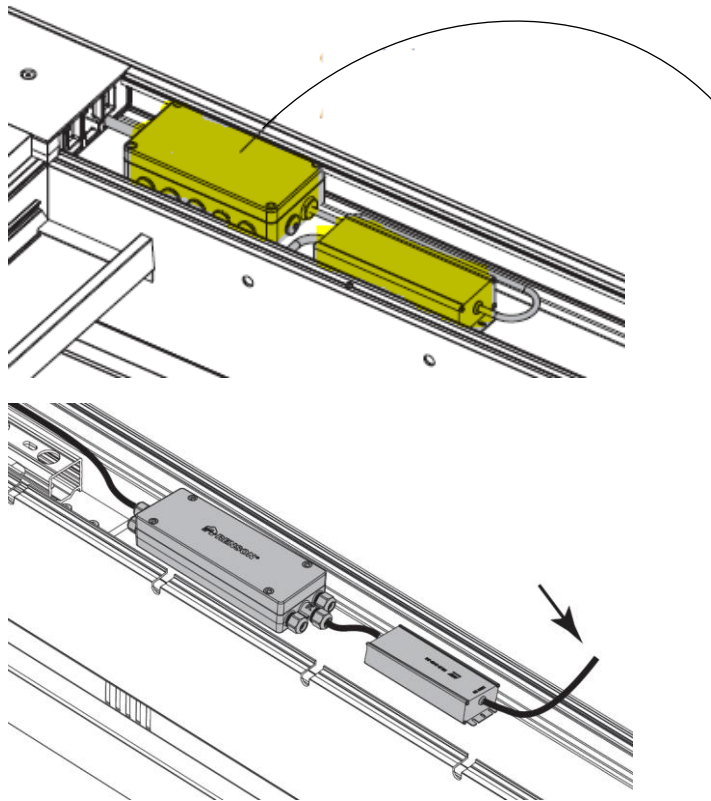

io label (for motor control until sept 2021)

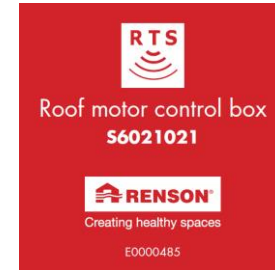

RTS label



FROST OFF

io label (for motor control from okt 2021)

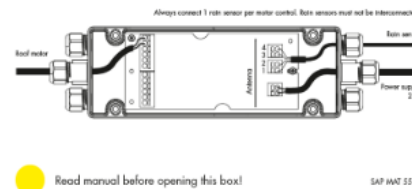

FROST ON

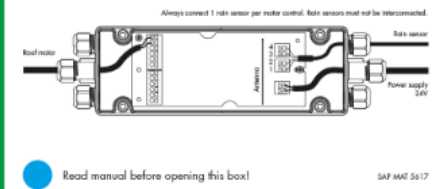

io installation

CAMARGUE + ALGARVE

- Motor control io

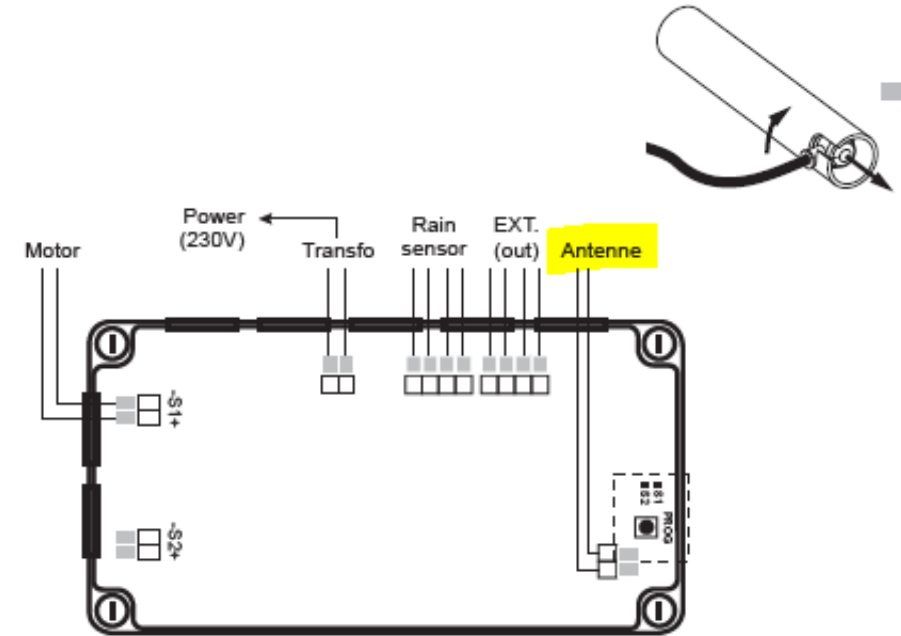
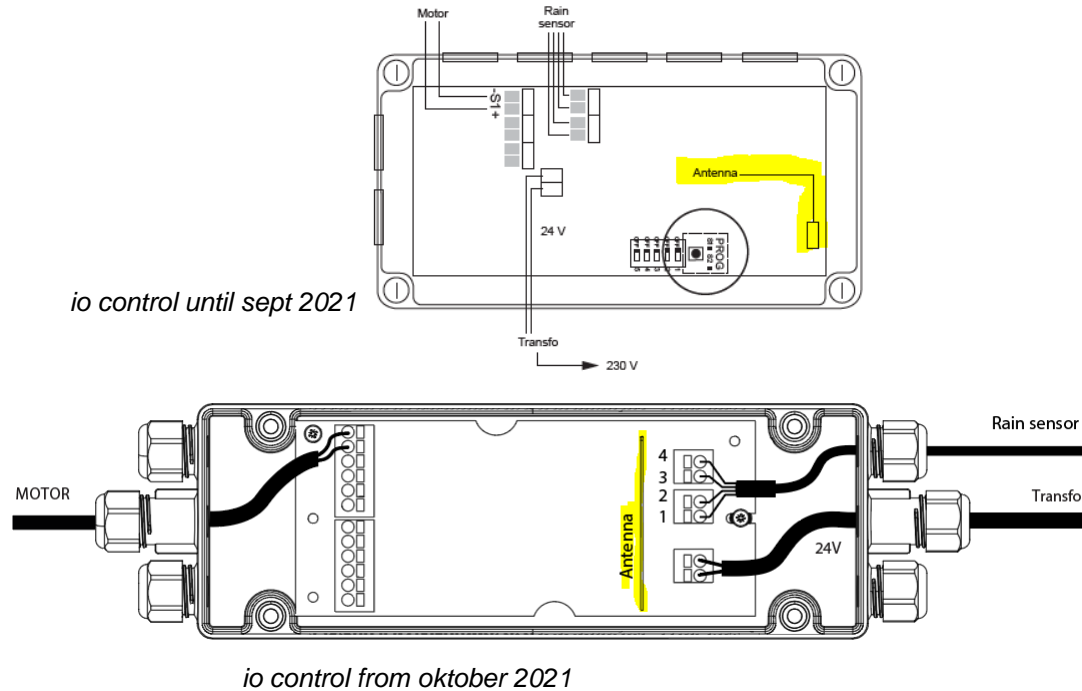

RTS with external antenna

io with internal antenna

Same situation io / RTS -> io range is better !

io installation

- Motor control io
- Led control io

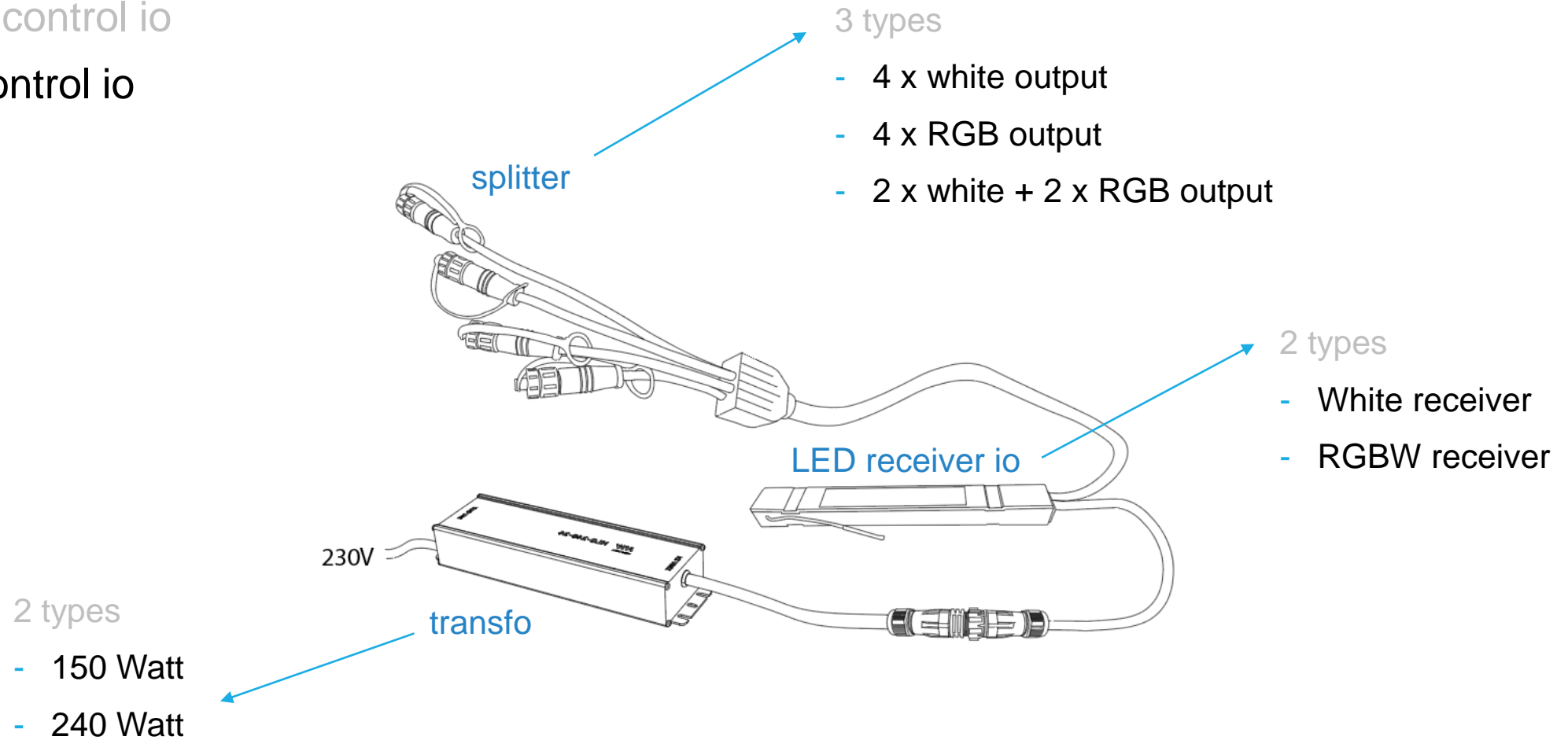

io installation

- Motor control io
- Led control io

Splitter 4 x white

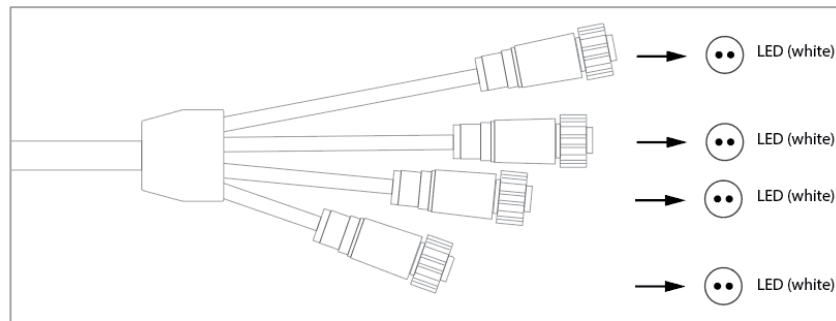

Lineo led - Updown led - Colomno led

Splitter 4 x RGBW

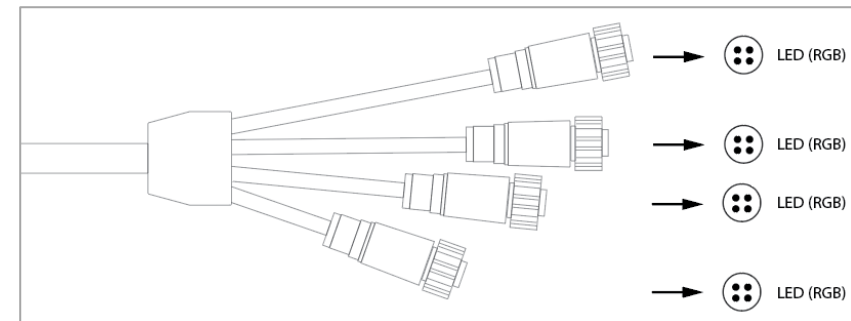

Up led



labels



labels

io installation

- Motor control io
- Led control io

Splitter 4 x white

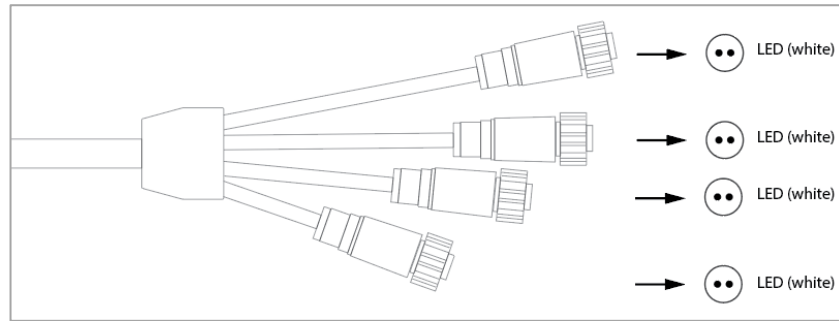

Lineo led - Updown led - Colomno led

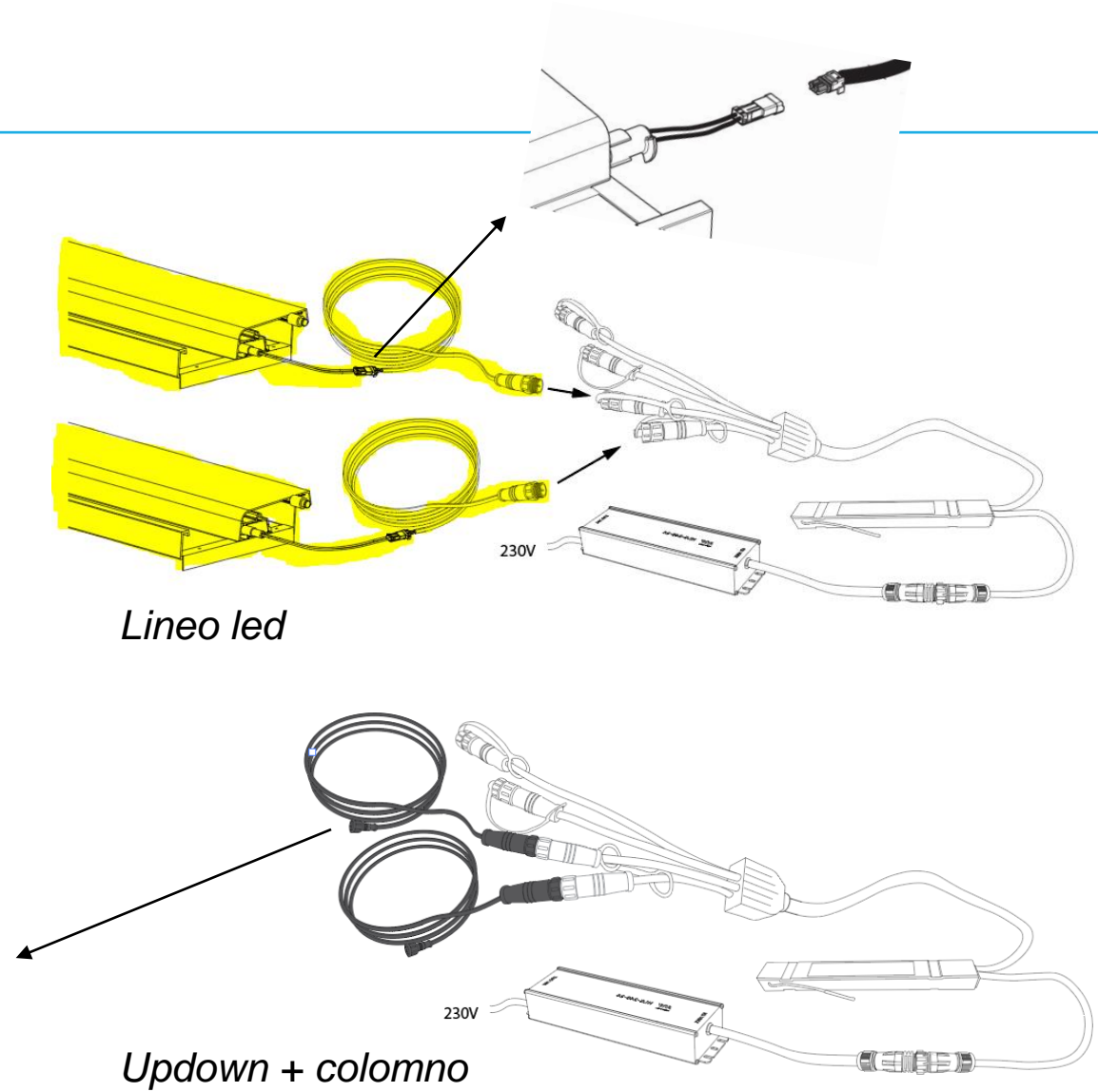
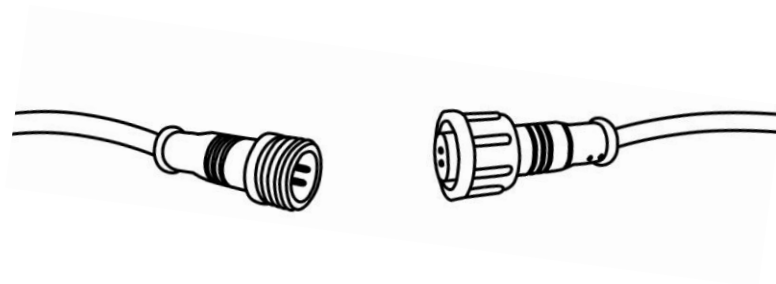

io installation

- Motor control io
- Led control io

Splitter 4 x RGB

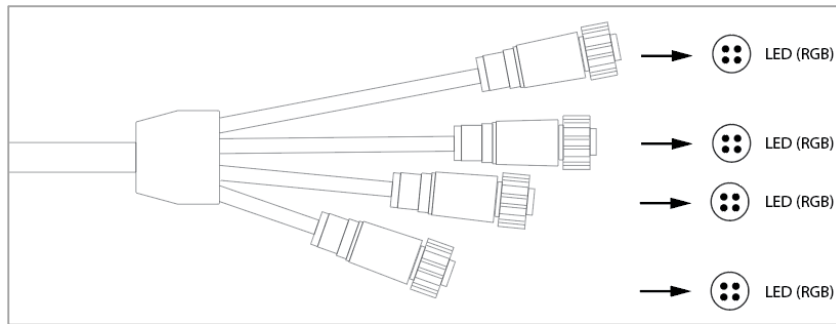

Up led

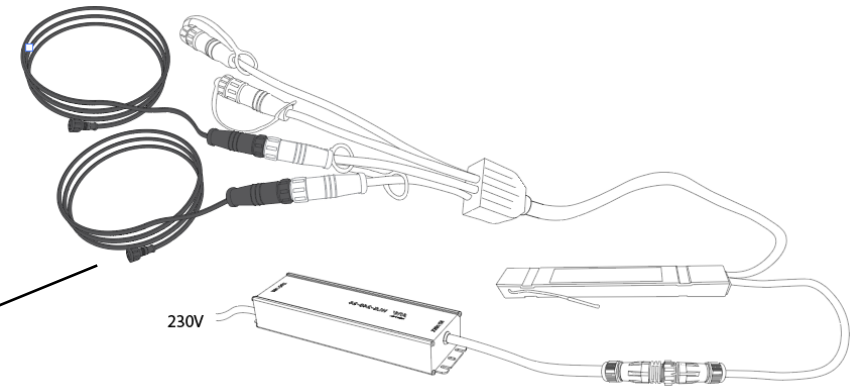
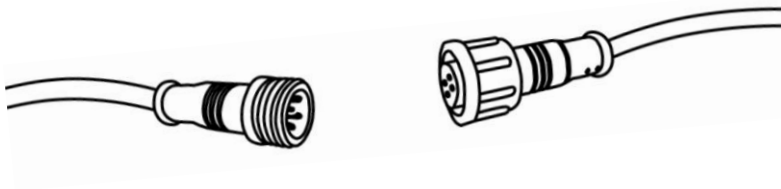

Up led RGB

io installation

- Motor control io
- Led control io

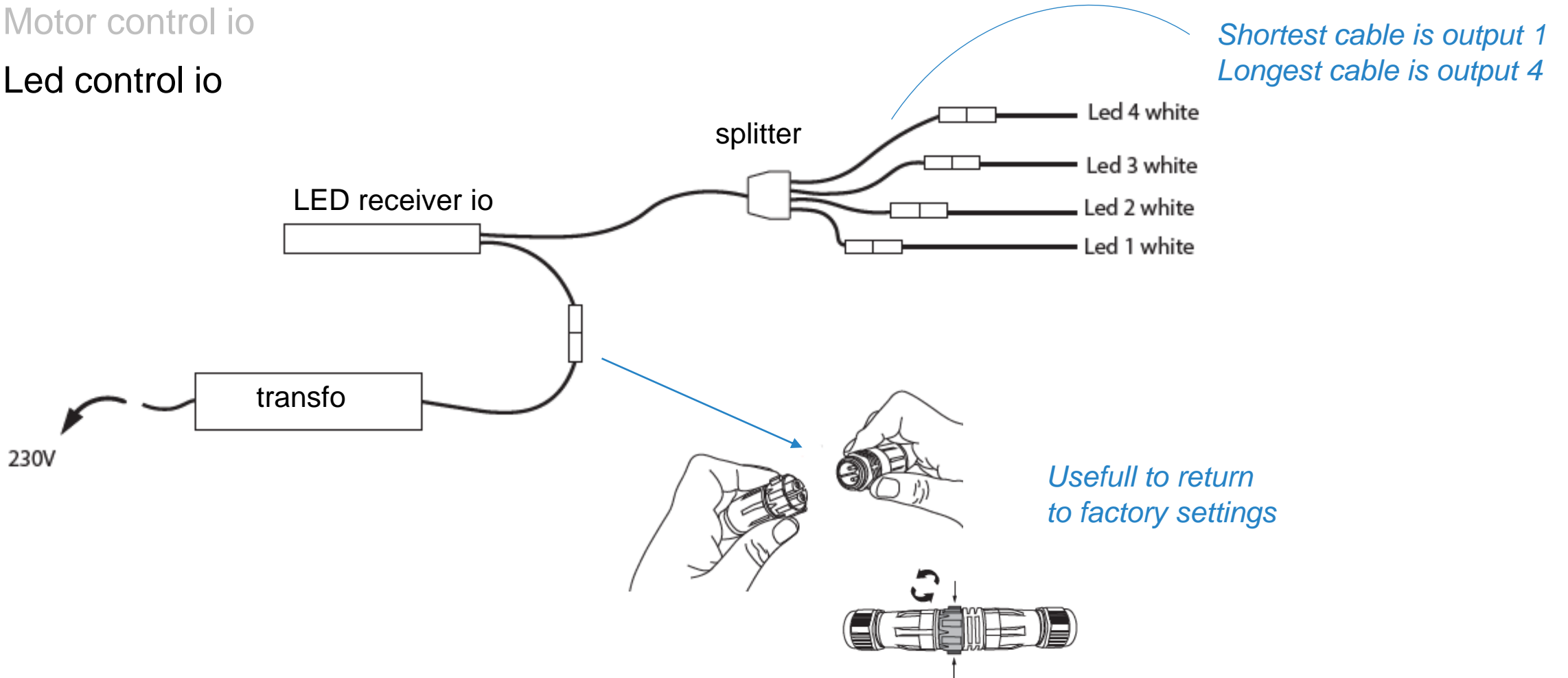

io installation

CAMARGUE + ALGARVE

- Motor control io
- Led control io
- Heat control io

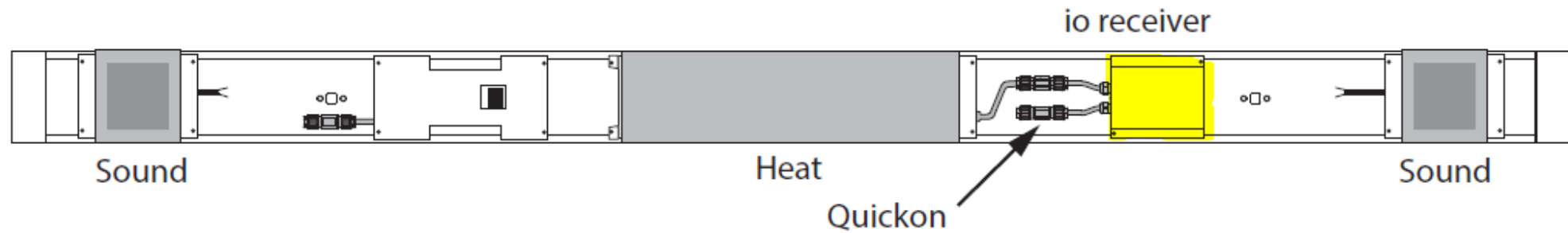

io receiver until end 2023



io receiver from 2024

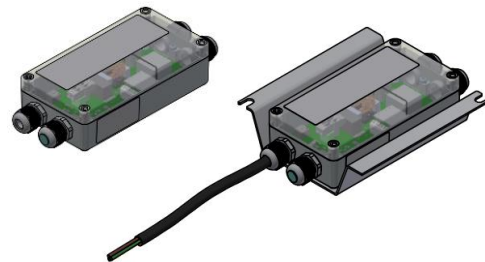

RTS receiver

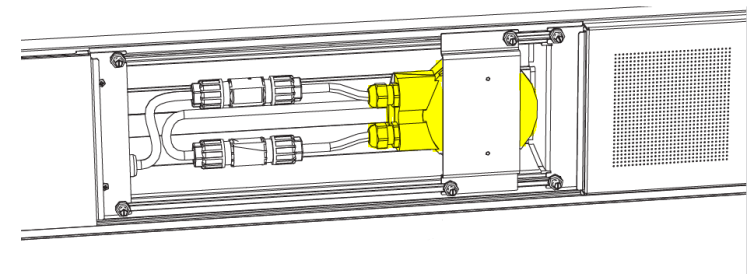

io installation

- Motor control io
- Led control io
- Heat control io
- Fixscreen control io

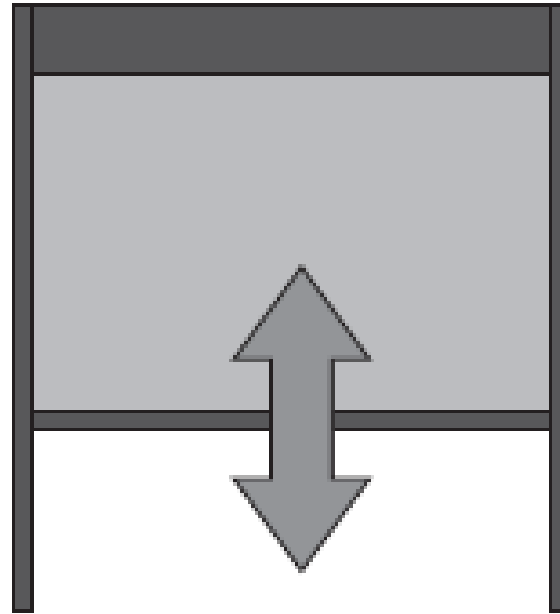

Rain sensor

CAMARGUE + ALGARVE

io + RTS = **G6020922**

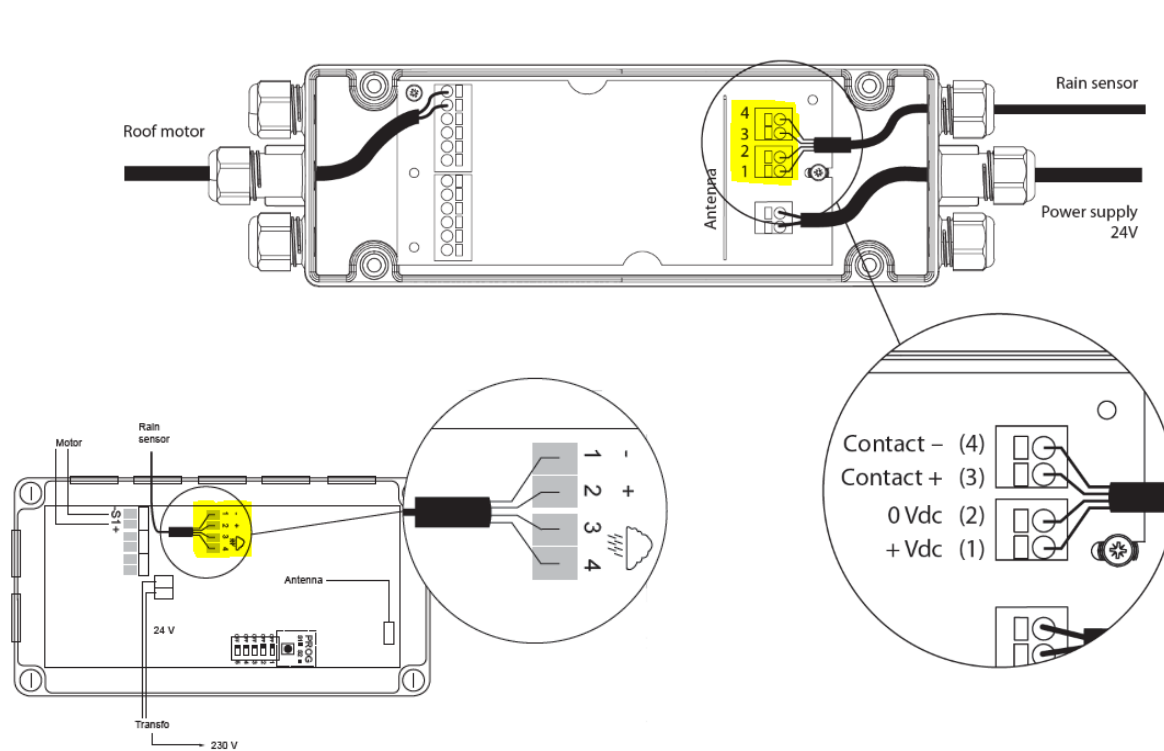
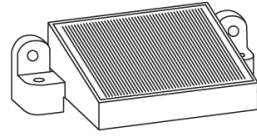

With io motor control

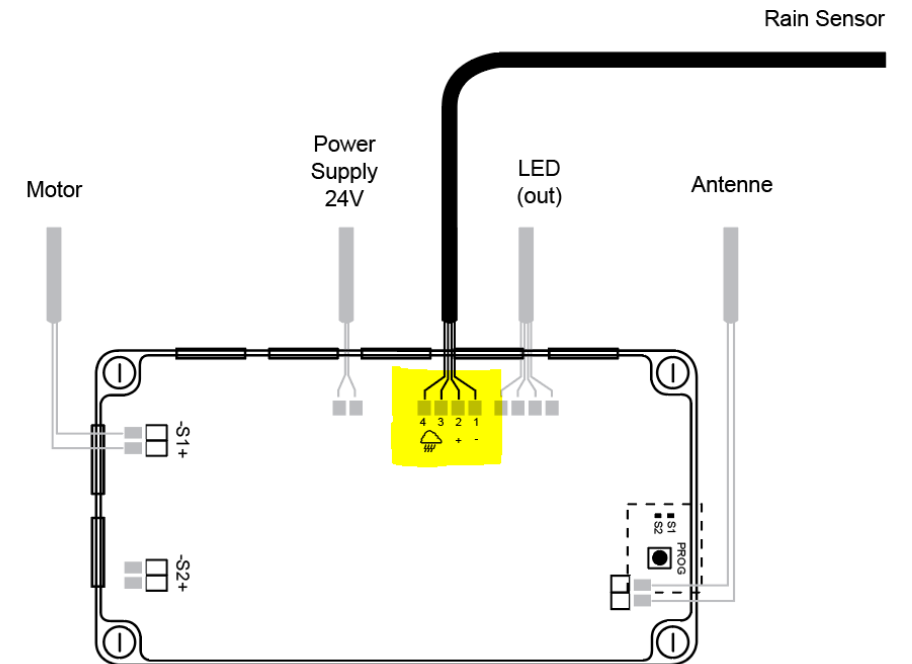

With RTS motor control

Rain + windsensor with Camargue/Algarve

Rain = Roof CLOSED + No reaction needed for Fixscreen

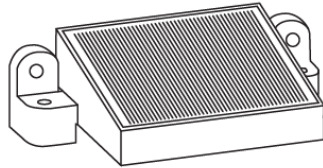

Rainsensor (G6020922)

Rain = Roof CLOSED + Fixscreen UP

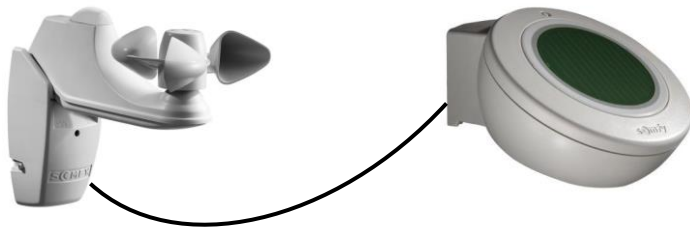

Windsensor Eolis io (G6000187)

+

Ondeis Rainsensor (G6002729)

Rain + windsensor with Lapure

Rain = Roof CLOSED

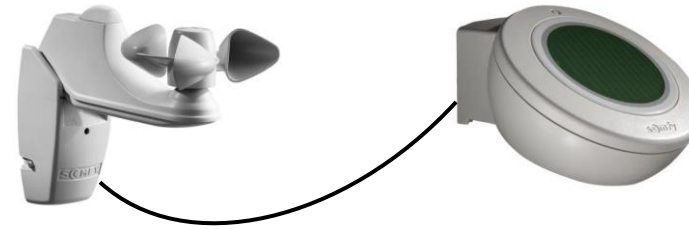
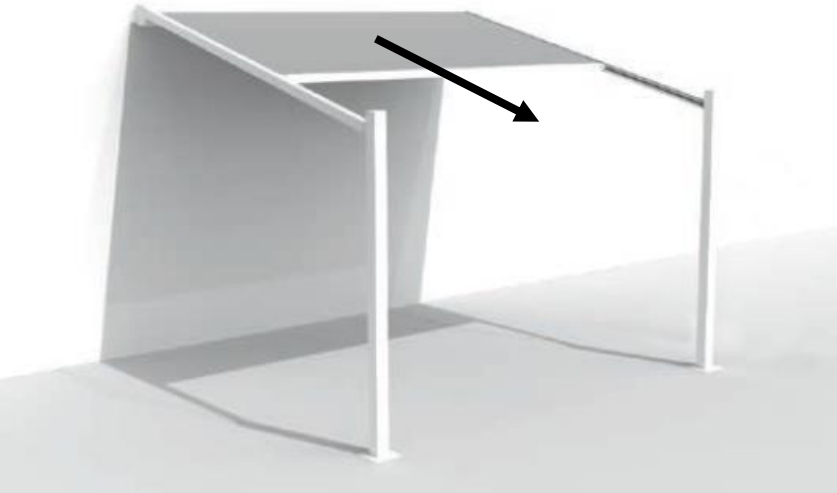

Windsensor Eolis io (G6000187)
+
Ondeis Rainsensor (G6002729)

Operating modes for 'Ondeis rainsensor' in combination with Eolis io:

- **Safety (S)**: screen up (roll in)
- **Comfort (C)**: screen down (roll out)

Rainsensor standard not activated!

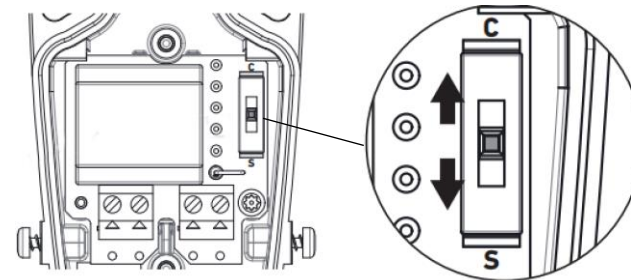

io control options

- Internet control (Smart home solution)
 - Tahoma box + app
 - Connexoon box + app



Tahoma (1 platform – possible with RTS or io)

Connexoon (Several apps: access-screens-terrace, only possible with io)

io control options

- Internet control
- Remote control (2-way)
 - Nina
 - Nina timer



io control options

- Internet control
- Remote control (2-way)
- Remote control (1-way)
 - Situo 1 io Pure II
 - Situo 5 io Pure II
 - Situo 5 VAR io Pure II

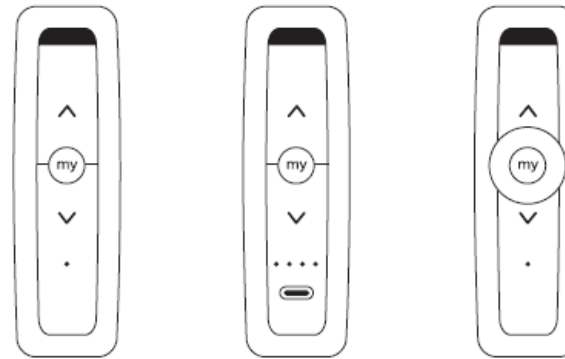

Situo io Pure II

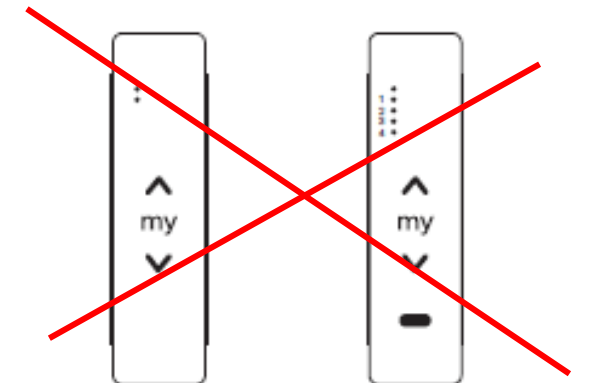

Situo io Pure*

Remote control Pure II design

Exist for **io** & **RTS**

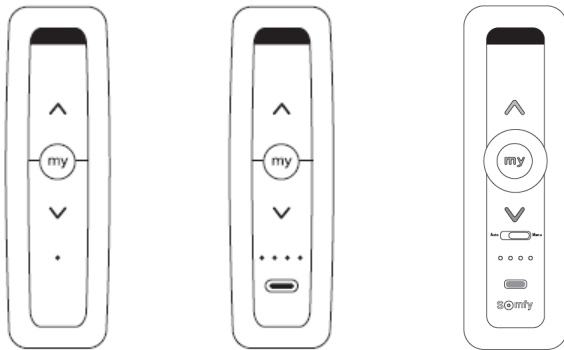

Situo io Pure II

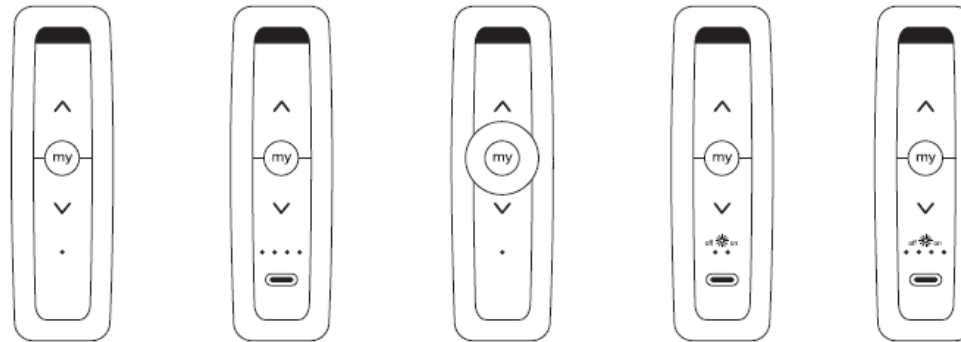

Situo RTS Pure II

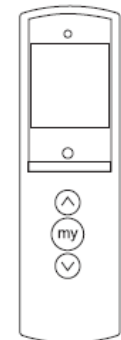

Telis 16 RTS Pure



io = green



RTS = red

Set & Go tool

- Programmation tool + software
- Easy tool to program
led / screen / heat / sensor
- Program of roof motor control
not possible with set & go tool
- Easy to:
 - set up, adjust and reset
 - made groups
 - couple windsensor
 - battery level windsensor
 - couple remotes
 - couple several motors, without separate power supply

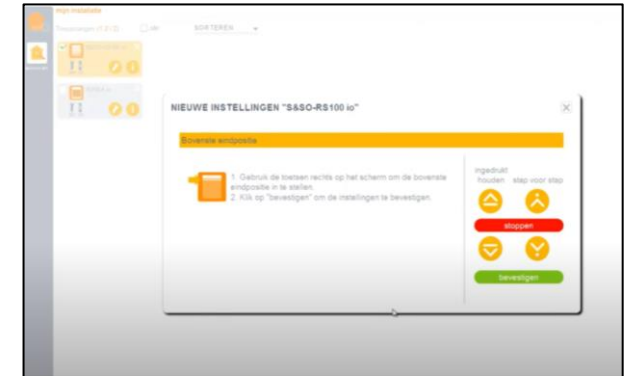

Set & Go tool

- Works without internet
- **Nina remote**
Roof: programming **not** possible
Screen: programming **not** possible
Adjusting endpoint possible
Led: programming possible
- **Situo remote**
Roof/Screen/Led: programming possible

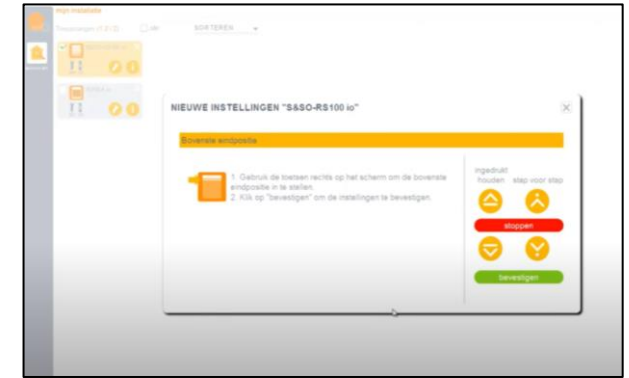

Programming roof always with situo!

RGB control possible with:

- **Situo 1 or 5 VAR io remote**

Scroll wheel = led intensity

Up/down button = colors

Important: Activate Modus 2 for the RGB channel

Led intensity is stepwise with scroll wheel

- **Nina remote / Tahoma app**

Led intensity is smooth (slider 0 – 100%)

Separate window to choose colour

1 icon/led -> 3 led-blades = 3 icons -> make group of led-blades

Nina: not possible to vary intensity of a group (only on/off) -> solution: make scenario

Tahoma: possible to vary intensity of a group

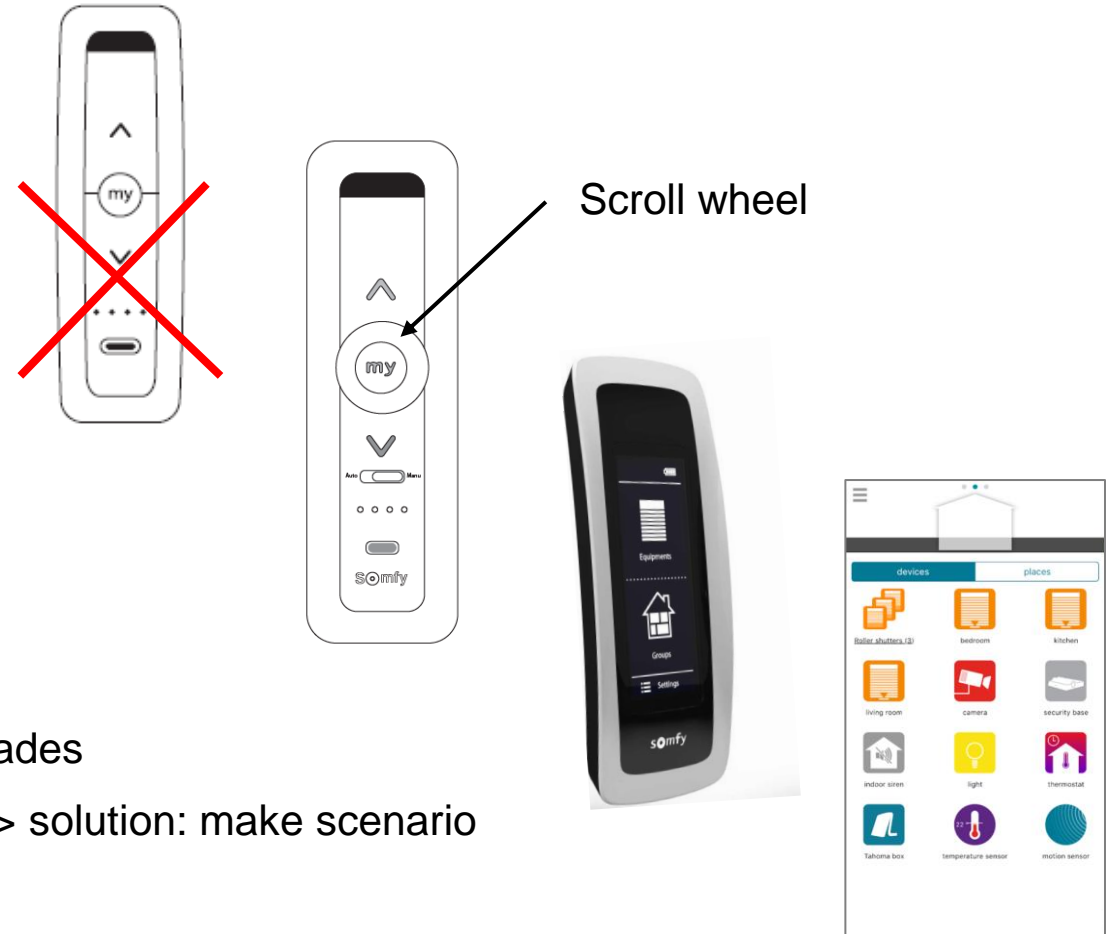

Remote control - RGB

CAMARGUE + ALGARVE

- 4 different modes possible on **situo VARIATION** remote
- On the back of the control
- Each channel can have a different modus

Modus 1: scroll no function

Modus 2: dimming leds (+ tilting blades)

Modus 3: interior sunshading

Modus 4: interior sunshading

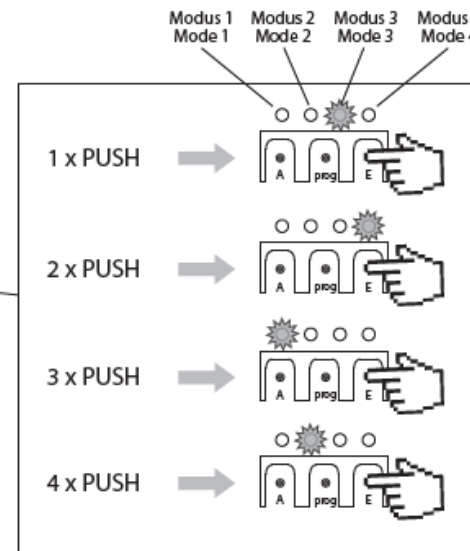
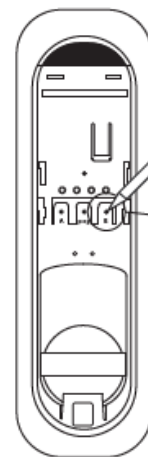
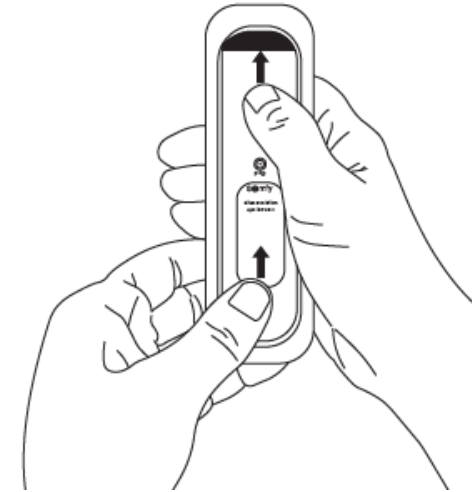
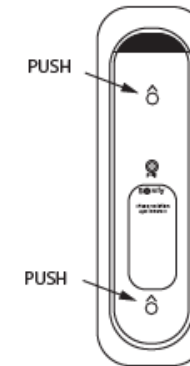
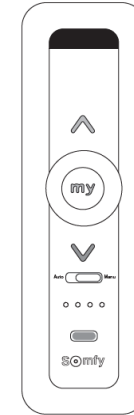

Roof control with io

CAMARGUE + ALGARVE

Valid for io motor control **until September 2021**

- Snow and frost is standard not activated !
- **Activate the snow position** by switching the 4th switch in the motor control box
- Frost and snow is same position with io (vertical 90°)
- Soliris remote doesn't exist for io
- If installer forgot to activate -> control box must open again!

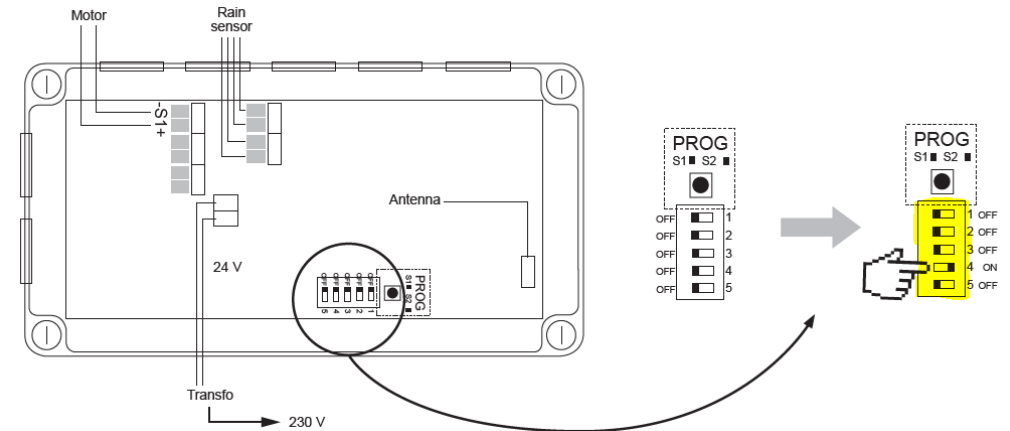

Roof control with io

CAMARGUE + ALGARVE

Valid for io motor control **from October 2021**

- When ordering the product, you were given the option of selecting the motor control with **active or inactive frost/snow** protection.

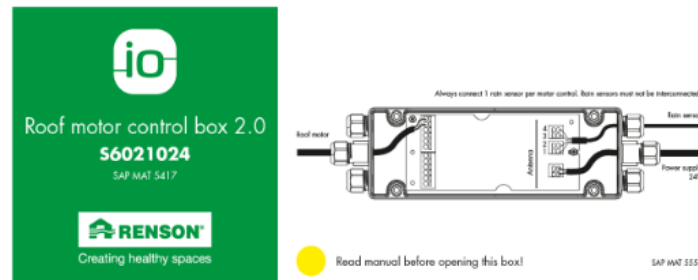

S6021024 = **INACTIVE** frost/snow protection

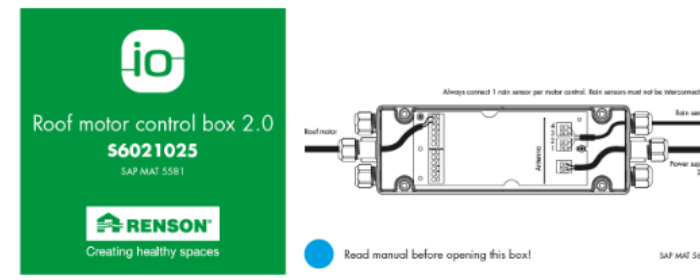

S6021025 = **ACTIVE** frost/snow protection

- You can still **change** this motor control setting during installation, but you can only do so via the **Somfy Set & Go installation tool**.
- Frost and snow can be selected **separately** with this io motor controller.
Recommended by Renson:
 - Frost position: the blades open slightly (5 to 10°) to prevent them from freezing shut
 - Snow position: the blades 90° vertical

- Not possible to overrule (with remote control) if roof is in frost-/snow position
Safety function which can overruled is not safety!
- Overrule would inactivate snow protection
User will then be responsible for damages
- Rain sensor not necessary to have snow protection

Temperature sensor

External temperature sensor (G6021127) doesn't work with io

Solution io

Temperature sensor [Somfy Thermis Wirefree io](#)

Works only with Tahoma (with scenario)



Heat control with io

- With optional io heating receiver
- Heat control io is also with a **dimmable receiver** since 2024

ON/OFF version until end 2023 (356 – S6024210)



Dimmable version from 2024

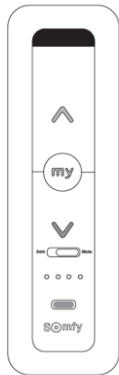

io



5711 (S6020496)
Control unit io heater Somfy

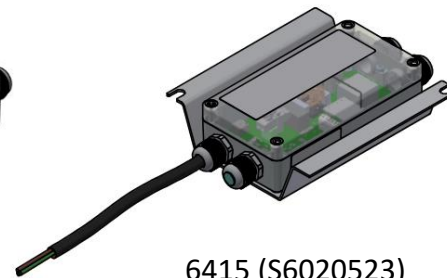

6415 (S6020523)
Control unit io heatbeam

